

Take your space to another level with these add-on ideas

Natural beauty

White oiled Douglas fir paired with pale buff bricks keeps the look light and spacious in this extension. 'The design focused on the expression of natural materials that would complement and respect the original Victorian house,' explains Oliver Leech, director of Oliver Leech Architects. 'The ruggedness of the internal brickwork sits wonderfully alongside the smooth matt walls and ceiling, and polished concrete worktop.'

GET THE LOOK Design by Oliver Leech Architects

lookbook

FEATURE YVETTE MURRELL

DESIGN DOSSIER: EXTEND

Through the roof

A big challenge when building an extension is marrying old with new. Here, the visual design of the rooftop deck blends the boundary between indoor and outdoor. 'Getting the new roofline to run parallel with the old proved tricky,' says Yvonne Meng, director at Circle Studio Architects. 'We spent time on site with the builder to line up the extension and the rafters of the existing house were measured and individually reset.'

GET THE LOOK Circle Studio Architects' loft conversion features Eco Timber charred timber cladding and is painted in Capital Blue by Dulux

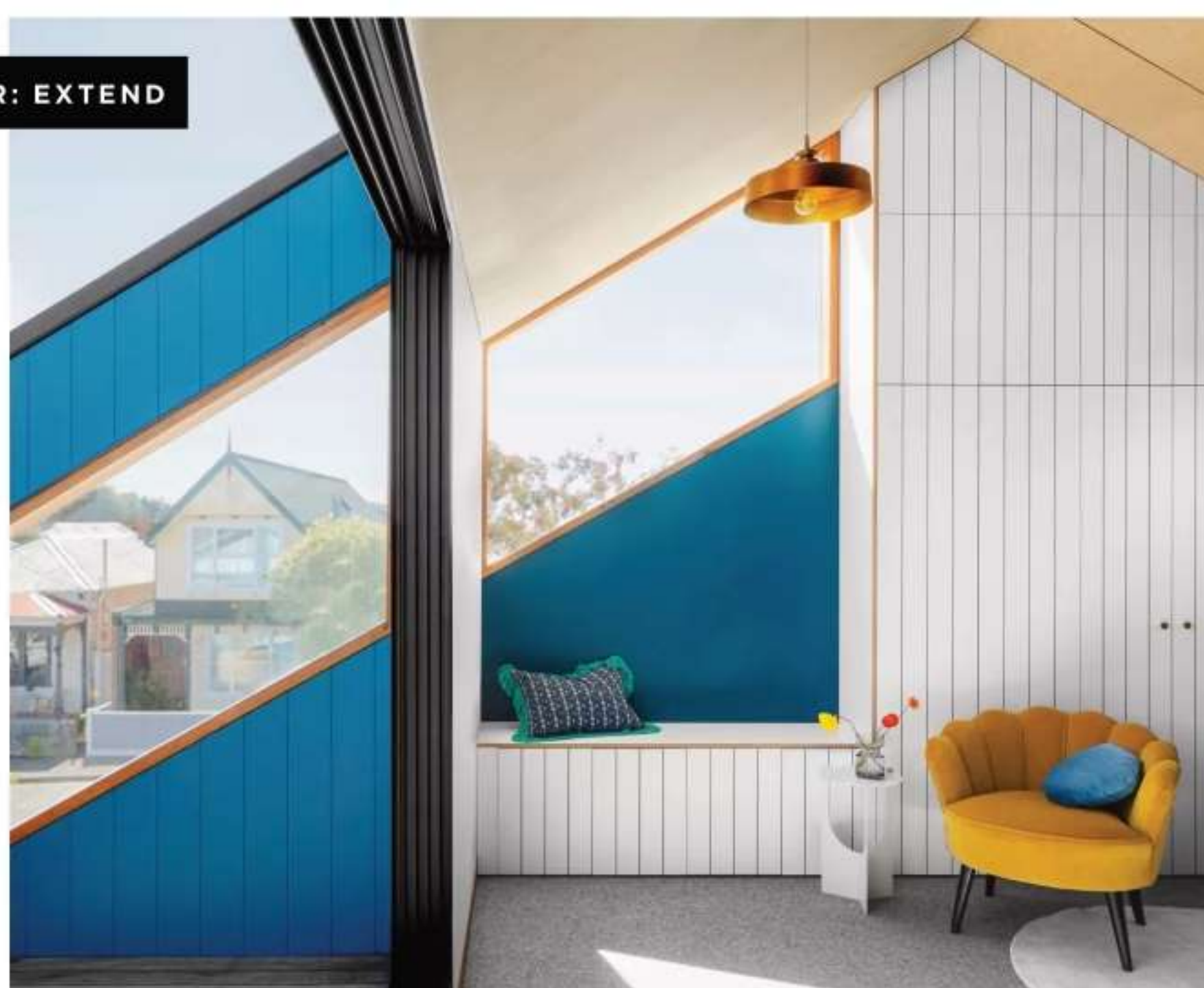

Bar service

Garden rooms have seen a huge surge in popularity, providing a separate space from the rest of the house to accommodate a home office, a relaxing retreat, a sociable bar space – or even a combination of all of the above. Here, a family with three children wanted to create a space that could adapt as the family grows. The garden room functions as a bar/entertaining space for the adults, as well as an office area when needed.

GET THE LOOK Garden room project by AO Architecture



Skyhigh

A double-height extension can be a show-stopping piece of architecture when light is allowed to flood through. The idea for this particular project came from the homeowner's love for the outdoors and taste for Nordic design. The focal point is a spacious double-height kitchen-diner at the rear of the property, which was created from the interplay of interlocking volumes made of frameless glass panels and linear timber panels. The cladding extends partially over the glass, patterning the light and providing shade.

GET THE LOOK Project by Paul Archer Design



PHOTOGRAPHS (THROUGH THE ROOF): MARTINA GEMMOLA, (SKY HIGH) ANDY STAGG

Home stretch

When it comes to designing a kitchen in your extension, it's important to focus on functionality, as Daniel Bowler, director for Eggersmann UK explains: 'Think about layout – how do you plan to use the space? Open-plan layouts are great, but you will want to zone each area. Include an island to separate the kitchen from the living area, creating an informal dining space without blocking out light.'

GET THE LOOK Eggersmann kitchen in a project by Such Designs. The total project cost around £100,000



DESIGN DOSSIER: EXTEND



Nestle in

One of the most popular places for an extension on British properties is the unused side passage. Here, a basement flat has been extended to add a galley kitchen, bathroom and an additional bedroom. But its most intriguing element is the exterior design. 'The garden side is expressed as a semi-circular gable with a circular window "eye" and cedar shingle feathers,' says architect Christian Ducker of Gundry Ducker. 'This conceals sloping roof lights that run the length of the extension.'

GET THE LOOK Side-return extension by Gundry Ducker

Under the weather

Animated by the sun and the rain through a carefully sculptured structure, this striking extension was designed to be enjoyed all year round. The curved section of the roof is cut in plan to allow maximum light into the courtyard, following the path of the sun across the site, and the roof is a thin 110mm structural shell perforated with round coffered skylights that echo the wave pattern of raindrops landing in the pool.

GET THE LOOK

Two-storey extension and house restoration by Tonkin Liu

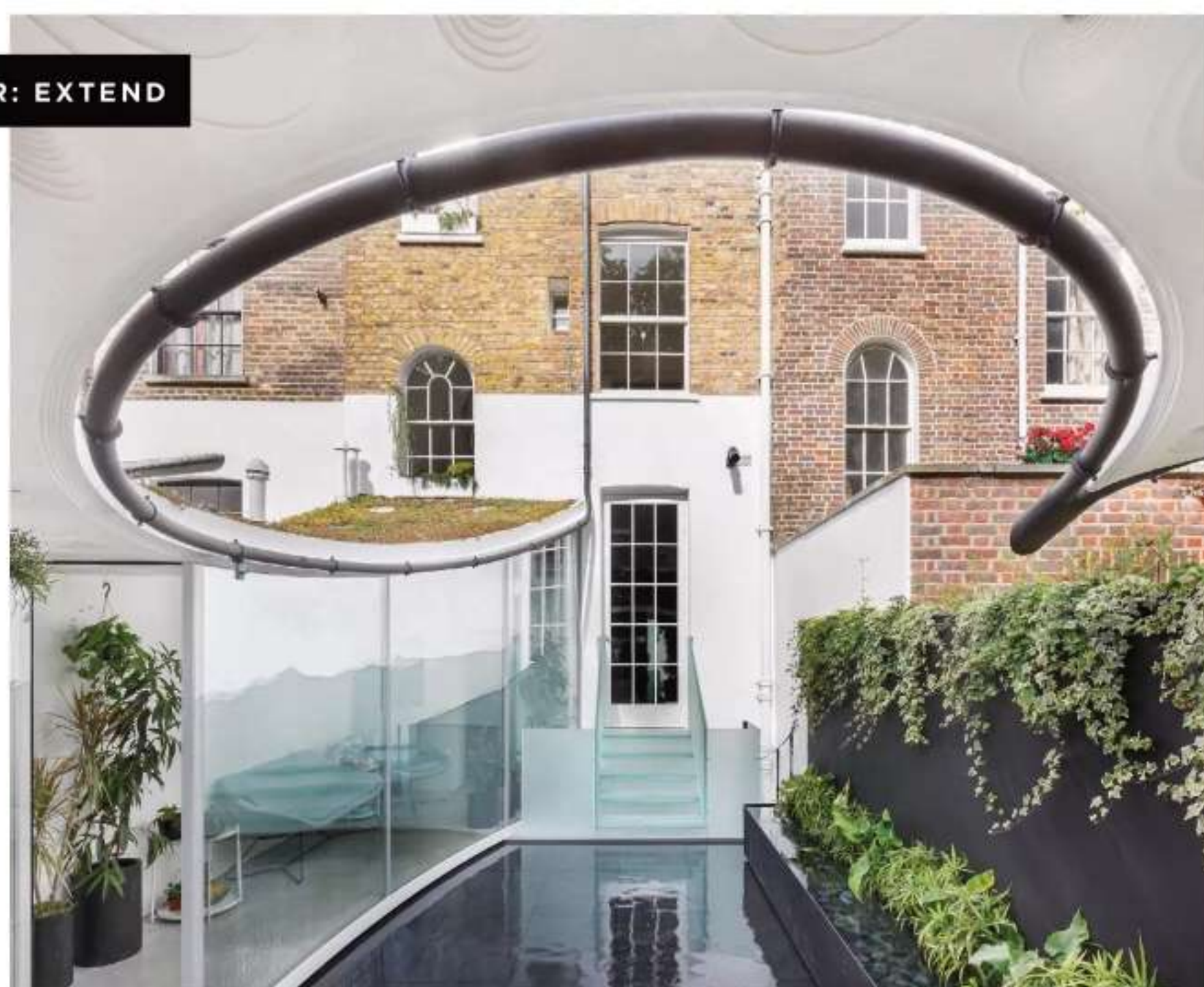

Inner circle

The secret to a creative extension? 'Use low-cost materials to create fun, playful shapes, and combine this with some bold materials and as much natural light as you can get your hands on,' says Will Fisher, co-founder of FAB Architects. 'Gain as much extra internal height as you can. Whether it's by pitching a roof or simply maximising the ceiling height, this extra sense of space turns a normal extension into something special.'

GET THE LOOK The Green House by FAB Architects features ply batons and industrial polycarbonate dome skylights to create a twin-pitched extension. It cost around £120,000



Urban legend

This 1980s end-of-terrace house has been extended to reactivate the unused spaces in the walled courtyard garden. The garage has been converted into a bedroom, connected to the house via this single-storey courtyard extension with an interesting glazed facade. 'We used corrugated aluminium to emphasise the pitched forms of the roof, while the material reflects the surrounding urban London landscape, vegetation and sky, changing with the light,' says Johan Hybschmann, who is a partner at Archmongers Architects.

GET THE LOOK This extension project is by Archmongers Architects



PHOTOGRAPHS (UNDER THE WEATHER) ALEXANDER JAMES; (INNER CIRCLE) GARETH GARDNER; (URBAN LEGEND) FRENCH & TYE

Dramatic turn

With the help of a good architectural designer, you can take inspiration from almost anywhere. Mat Barnes, director of Studio CAN, exposed steel beams as a nod to the lighting rigs of theatres in this creative extension. 'The crumbling walls leading to the extension reference the dealer's flat in *Trainspotting*. I thought it was a perfect way to retain a memory of the state we found the house in,' says Mat.

GET THE LOOK Edwardian semi-detached house project by Studio CAN. Worktop and unit fronts made of recycled chopping boards and milk bottle tops, Smile Plastics