

# New ARRIVAL

Ahead of the birth of their second child, the owners of this Victorian terraced house sought the help of interior designer Clare Altarafi to treat their four-year-old daughter to her own, redecorated bedroom

Words: Yvette Murrell Photography: Susie Pope Photography

"I made a feature of one of the walls with polka dot-style decals, which can be removed at a later date if needed," Clare says. "The chest of drawers and wardrobe were originally pine, so the couple painted them in Diorite, a purple-toned grey paint by local company Paint The Town Green, for an update. It is free of toxic fumes – which is particularly reassuring when painting a child's bedroom. I also updated both pieces with oversized handles for a contemporary look. I then chose **wooden knobs** from This Modern Life for the chest of drawers, and **brushed brass knobs** from Anthropologie to tie in with the metal bed frame." **Wall decals**, Molly Meg; **pineapple mirror**, This Modern Life.

"The couple approached me to help design their four-year-old daughter's new bedroom – the mother was pregnant again, so the little girl was going to move into a new space," designer Clare Altarafi of Clare Elise Interiors remembers. "With a clear deadline and budget, they were happy to do much of the decorating, so I started with putting together a moodboard. The brief was for a modern, beautiful, but not too girly space that would see her through the next few years." **Bed**, The Original Bed Company; **bedside table**, Maisons du Monde; **wall prints**, This Modern Life; **canopy**, **star garland**, **bed linen**, and **cloud rug**, Molly Meg.



## THE FACTS

**Who?** A family  
**What?** Resdesigning a child's room in a five-bedroom Victorian terraced house  
**Where?** Earlsfield, south west London  
**Cost?** £2500  
**Time?** Five weeks

## DESIGN EDIT



- 1 Cam Cam organic cotton canopy in Dusty Pink, £106, [Smallable](#). **smallable.com**  
 2 Sweet grey pine wardrobe, £378, Maisons du Monde. [maisonsdumonde.com](#)  
 3 Dots wallpaper by Karlie Klum, £28 per 3m roll, Lime Lace. [limelace.co.uk](#)  
 4 Alphabet A3 print, £14, Bobby Rabbit. [bobbyrabbit.co.uk](#)  
 5 New York metal kids bed in red, £199, Cuckooland. [cuckooland.com](#)



"I wanted to make sure the design would last as the little girl grew up," Clare explains. "The couple didn't want to have to completely redecorate again in a few years. In this scheme it is easy to change accessories and decorations, but we kept the bare bones, such as the walls, fairly neutral for longevity." **Wall paint**, Private Universe, Paint The Town Green; **Miffy lamp**, This Modern Life.

"Formerly a spare bedroom, the space is rectangular but has a slightly odd layout, with the entrance to a walk-in cupboard effectively splitting the back wall in half," Clare says. "The couple wanted a cost-effective way to use both spaces without spending additional money to knock the wall through and join the main room and cupboard into one, so we created a reading nook with books on easily accessible **display shelves**, from Ikea, in there. We made it a nice and cosy spot and added cool prints on the walls and a comfy beanbag."

**Neon heart**, This Modern Life; **desk**, Ikea; **stool**, Molly Meg.



"When it came to the room's design scheme, the couple knew they didn't want it to be overly girly," Clare remembers. "They had already picked out a bed they liked online – a wrought-iron traditional frame. However, they were keen to make the overall look feel modern, which I helped them with. Together we opted for a monochrome feature wall, with playful colour pops – balancing pastel shades with more vibrant pinks and offsetting these with strong mint tones." **Brushed brass knobs on wardrobe**, Anthropologie.

## THE PLANS

Previously a spare bedroom, Clare updated the space to be more suitable for the couple's four year-old daughter. Making no structural alterations, she instead used the available floor area in the most effective way and made the decoration easy to change.

- 1 Layout** While most of the arrangement remained the same, a new bed and desk were added.  
**2 Use of space** A reading nook was created in a small cupboard.

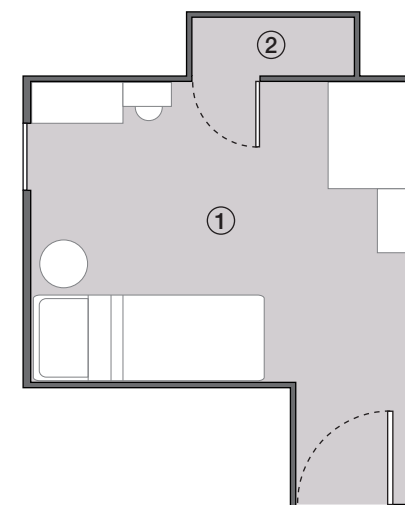

## SOURCE BOOK

**Interior designer** Clare Altarafi, Clare Elise Interiors 07790 521928, [clareeliseinteriors.com](#)  
**Bed frame** The Original Bed Company 0800 464 0875, [obc-uk.net](#)  
**Paint** Paint The Town Green 020 8871 0531, [paintthetowngreen.co.uk](#)  
**Pendant light** Maisons du Monde 0808 234 2171, [maisonsdumonde.com](#)  
**Canopy** Molly Meg 020 7359 5655, [mollymeg.com](#)  
 For full stockist information, turn to page 156 **KBB**